



Sony CPF-IP001 Remote Battery Replacement

Use this guide if your remote stops...

Written By: Marlena Perez



INTRODUCTION

Use this guide if your remote stops functioning. Be sure to have a replacement battery available. The type of battery you will need is a 3 Volt CR2032.

PARTS:

[CR2032 Lithium Battery](#) (1)

Step 1 — Remote Battery



- Open battery tray by pushing right on the boxed tab and pulling the battery tray out.

Step 2

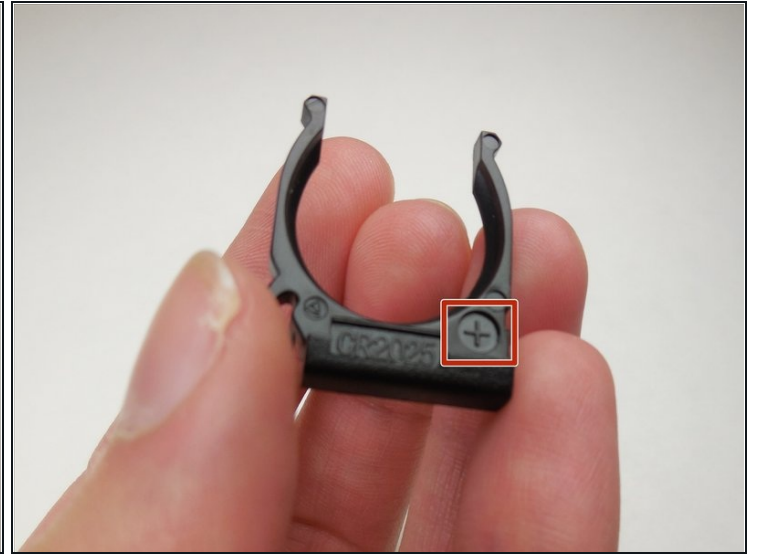

- Replace battery.
- When placing your new battery in the tray, make sure the positive side on the battery and the positive side on the tray are both facing up.

To reassemble your device, follow these instructions in reverse order.